

M/T 208

Order designation

Polycarbonate enclosure Order no.

M 208 02208000

(G = with clear lid)

ABS enclosures

Order no.

T 208 03208000

T 208 SV 03208400

(SV = quick-release fastening)

Accessories (additional charge)

Order no.

F: Set of rubber feet = 4 pcs

22003300

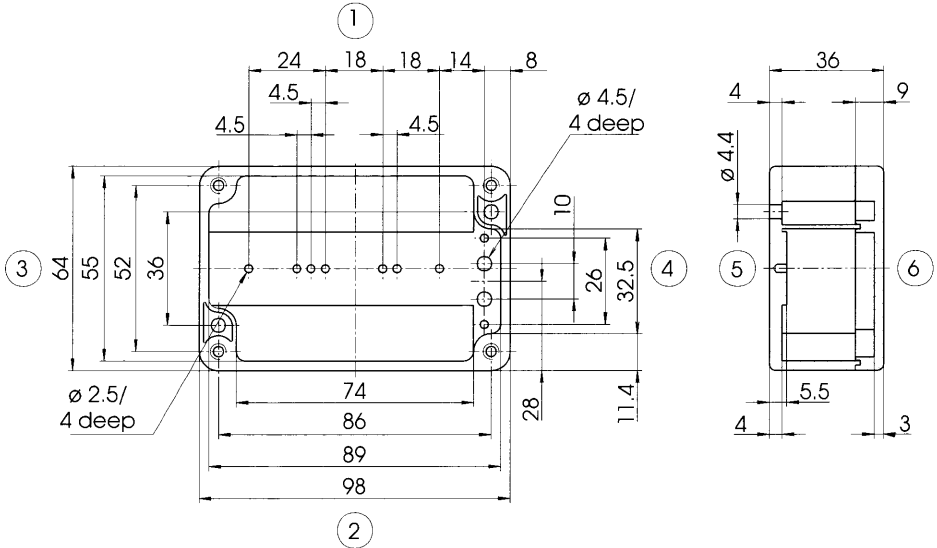

FIO 1217-500 = 03208000

<p>Enclosure material: Polycarbonate, ABS. For technical data see pages 7.4 - 7.7.</p> <p>Colour: Light grey, similar to RAL 7035. Special colours on request for orders of 500+.</p> <p>scope of delivery: Upper and lower section; lid screws made of V2A; self-tapping screws for mounting bosses.</p> <p>Ingress protection: IP65/DIN VDE 0470; increased protection on request.</p> <p>Lid seal: Sponge cord (neoprene) in lid groove. For technical data see pages 7.13.</p>	<p>Accessories (additional charge):</p> <p>M: Mounting plate, laminated paper (Pertinax), Zinc-coated steel for model 260</p> <p>RD: Set of knurled screws = 4 pcs</p> <p>F: Set of rubber feet = 4 pcs</p> <p>SIL: Lid with silicone seal</p> <p>WL: Set of wall brackets = 4 pcs</p> <p>TS 15: Top hat rail DIN EN 50045 – 15 x 5</p> <p>TS 32: G-rail DIN EN 50035 – G 32</p> <p>TS 35: Top hat rail DIN EN 50022 – 35 x 7.5</p> <p>SchM: Hinge for M/T</p>	<p>Notes:</p> <ul style="list-style-type: none"> - We recommend fitting the mounting plate or the DIN-rails with the self-tapping screws (included with the enclosure) - Threaded inserts are required for assembly with metric screws. See page 6.31 - Cable glands, see page 6.12 ff - Terminal assignment, see page 5.47 - Material shrinkage may result in ABS enclosures being approx. 0.1 - 0.25% larger than the PC enclosures illustrated
---	---	---

Polycarbonate enclosures				ABS enclosures				External dim.		
Model	Order no.	Model	Order no.	Model	Order no.	Model	Order no.	L	W	H
M 205	02205000	M 205 G	02205400	T 205	03205000	T 205 SV	03205400	52	50	35
M 206	02206000	M 206 G	02206200	T 206	03206000	T 206 SV	03206400	65	50	35
M 208	02208000			T 208	03208000	T 208 SV	03208400	98	64	36
M 210	02210000	M 210 G	02210100	T 210	03210000	T 210 SV	03210400	82	80	55
M 215	02215000	M 215 G	02215100	T 215	03215000	T 215 SV	03215400	120	80	55
M 216	02216000	M 216 G	02216100	T 216	03216000	T 216 SV	03216400	120	80	60
M 217	02217000	M 217 G	02217200	T 217	03217000	T 217 SV	03217400	122	120	55
M 219	02219000			T 219	03219000	T 219 SV	03219400	160	80	60
M 220	02220000	M 220 G	02220100	T 220	03220000	T 220 SV	03220400	160	80	55
M 221	02221000	M 221 G	02221100	T 221	03221000	T 221 SV	03221400	200	120	75
M 223	02223000	M 223 G	02223100	T 223	03223000	T 223 SV	03223400	200	150	75
M 225	02225000	M 225 G	02225100	T 225	03225000	T 225 SV	03225400	82	80	85
M 226	02226000	M 226 G	02226100	T 226	03226000	T 226 SV	03226400	120	80	85
M 227	02227000	M 227 G	02227100	T 227	03227000	T 227 SV	03227400	122	120	85
M 228	02228000	M 228 G	02228100	T 228	03228000			122	120	105
M 230	02230000			T 230	03230000	T 230 SV	03230400	120	80	90
M 231	02231000	M 231 G	02231100	T 231	03231000	T 231 SV	03231400	160	80	85
M 235	02235000			T 235	03235000	T 235 SV	03235400	160	80	90
M 237	02237000	M 237 G	02237100	T 237	03237000	T 237 SV	03237400	200	120	90
M 238	02238000	M 238 G	02238100	T 238	03238000	T 238 SV	03238400	160	120	90
M 240	02240000	M 240 G	02240100	T 240	03240000	T 240 SV	03240400	250	160	90
M 2401	02240200	M 2401 G	02240300	T 2401	03240200	T 2401 SV	03240240	240	160	90
M 241	02241000			T 241	03241000	T 241 SV	03241400	250	160	120
M 242	02242000	M 242 G	02242100	T 242	03242000	T 242 SV	03242400	240	120	100
M 243	02243000	M 243 G	02243100	T 243	03243000	T 243 SV	03243400	240	160	120
M 244	02244000	M 244 G	02244100	T 244	03244000			340	150	100
M 245	02245000			T 245	03245000			340	150	120
M 246	02246000	M 246 G	02246100	T 246	03246000			160	120	140
M 250	02250000			T 250	03250000			250	160	150
M 251	02251000			T 251	03251000	T 251 SV	03251400	360	160	100
M 252	02252000							300	230	65
M 253	02253000	M 253 G	02253100	T 253	03253000	T 253 SV	03253400	300	230	85
M 254	02254000	M 254 G	02254100	T 254	03254000	T 254 SV	03254400	300	230	110
M 255	02255000	M 255 G	02255100	T 255	03255000	T 255 SV	03255400	360	200	150
				T 260	03260000			400	360	150

G = clear lid

SV = quick-release fastening