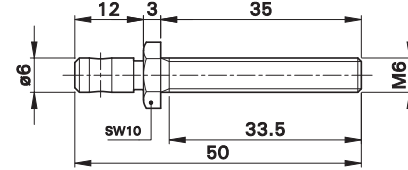
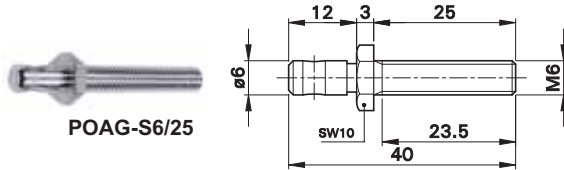
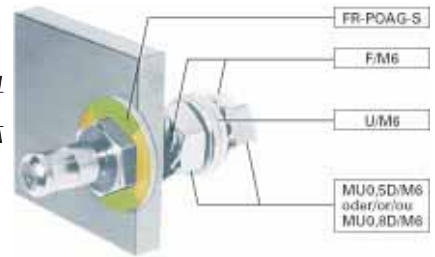
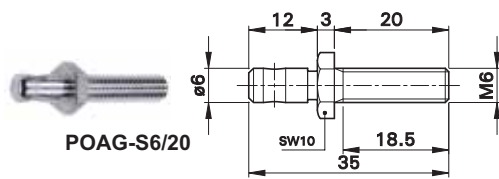
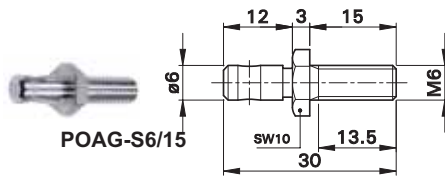

**Steckverbinder  
für den Potenzialausgleich**
**Plug Connectors  
for Potential Equilization**
**Connecteurs pour  
liaisons équipotentielles**
**POAG-S6/...**

Ø 6 mm-Stecker aus vernickeltem Messing zum Anschrauben an Geräte, Betten oder Wand-schienen für den Potenzialausgleich. Vier Normlängen lieferbar, andere Längen auf An-frage. **Lieferung ohne Montagematerial!**

Ø 6 mm plugs made of nickel-plated brass, to screw into instruments, beds or wall rail-potential equilization. Delivered in four stan-dard lengths, other lengths on request. **The assembly material is not supplied!**

Fiches Ø 6 mm en laiton, nickelées à visser sur appareils, lits ou rails muraux pour liaisons équipotentielles. Livrables en quatre longueurs standard. Autres longueurs sur demande ! **Livrées sans matériel de fixation !**

Typ Type Type	Best.-Nr. Order No. N° de Cde		
POAG-S6/15	04.0056	Ni	
POAG-S6/20	04.0057	Ni	
POAG-S6/25	04.0058	Ni	
POAG-S6/35	04.0059	Ni	

**Montagematerial**

Farbmarkierungsscheibe:  
FR-POAG-S, Best.-Nr. 14.5010  
Fächerscheibe (DIN 6798):  
F/M6, Best.-Nr. 08.0704  
Mutter (DIN 439):  
MU0,5D/M6, Best.-Nr. 08.0501  
Mutter (DIN 934):  
MU0,8D/M6, Best.-Nr. 08.0502  
U-Scheibe (DIN 125):  
U/M6, Best.-Nr. 08.0601

**Assembly material**

Colour code washer:  
FR-POAG-S, Order No. 14.5010  
Serrated lock washer (DIN 6798):  
F/M6, Order No. 08.0704  
Nut (DIN 439):  
MU0,5D/M6, Order No. 08.0501  
Nut (DIN 934):  
MU0,8D/M6, Order No. 08.0502  
Washer (DIN 125):  
U/M6, Order No. 08.0601

**Matériel de fixation**

Rondelle de repérage :  
FR-POAG-S, N° de Cde 14.5010  
Rondelle éventail (DIN 6798) :  
F/M6, N° de Cde 08.0704  
Écrou (DIN 439) :  
MU0,5D/M6, N° de Cde 08.0501  
Écrou (DIN 934) :  
MU0,8D/M6, N° de Cde 08.0502  
Rondelle (DIN 125) :  
U/M6, N° de Cde 08.0601

