

**X**  
Kontaktanordnung  
contact arrangement

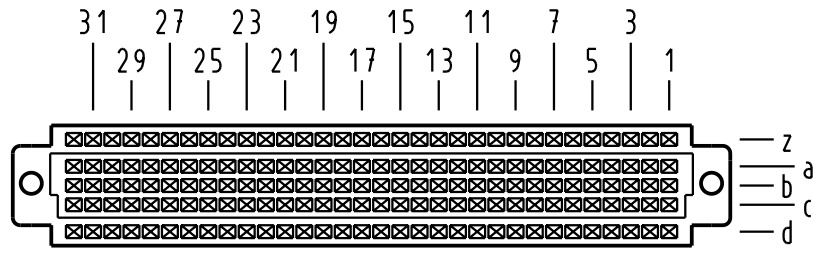

160 Signalkontakte  
160 signal contacts

- ☒ = Kontaktposition belegt  
= position with contact
- ☐ = Kontaktposition nicht belegt  
= position without contact

**Z**  
2:1

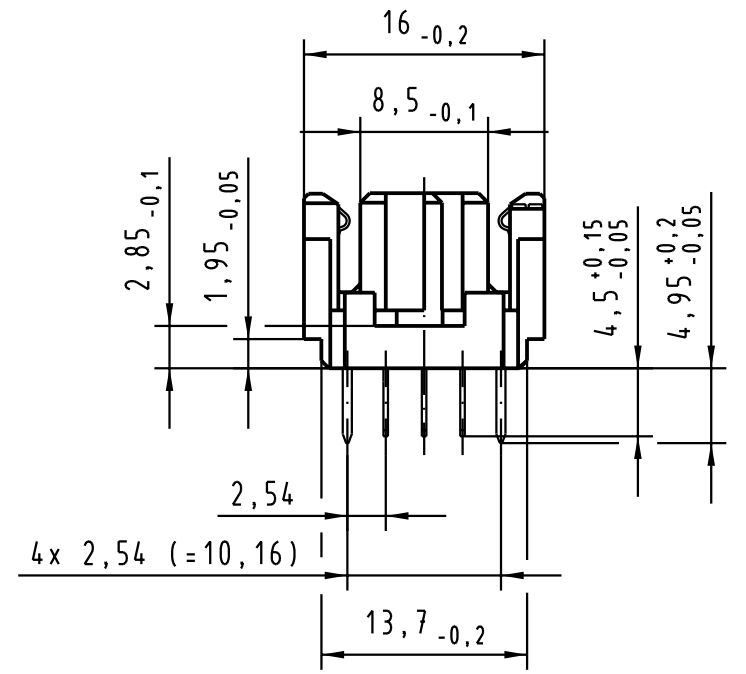

**X**  
(Lochbild)  
(board drillings)

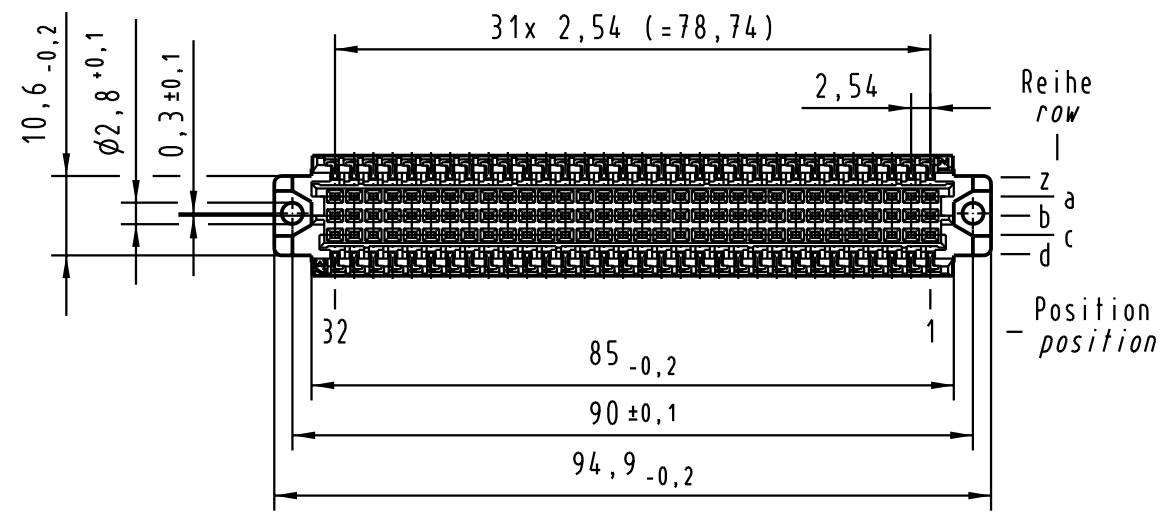
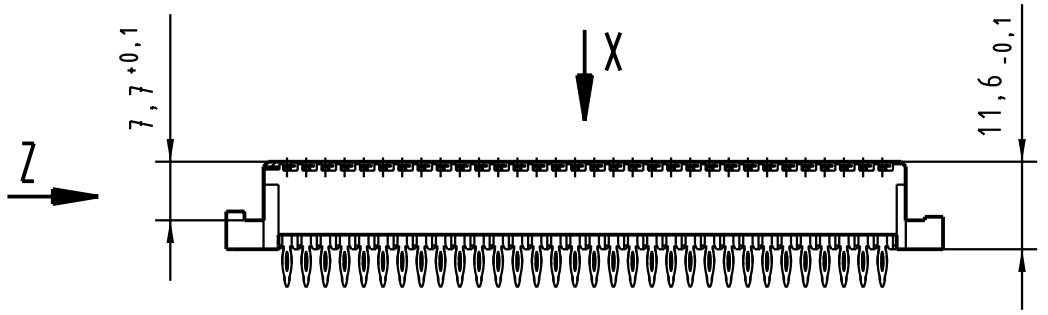
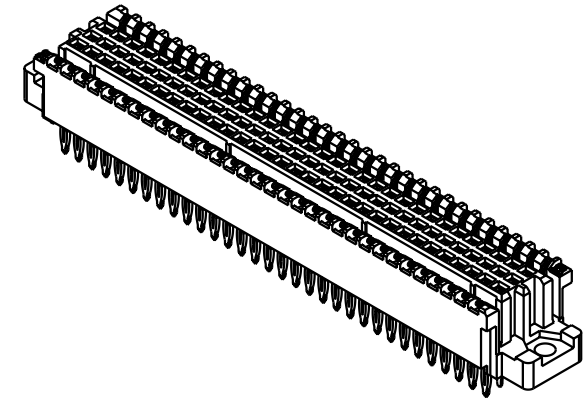
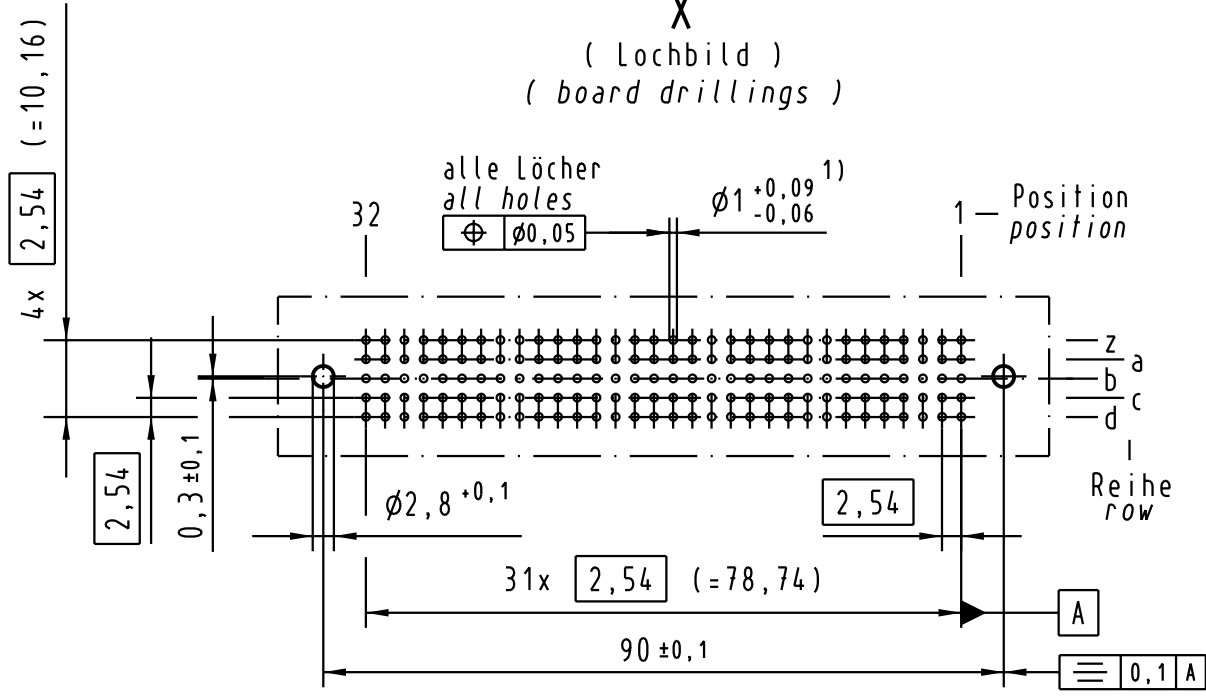

1) Für Einpreßverbindung nach IEC 352-5  
1) For press-in connection acc. to IEC 352-5

02 02 160 <u>2</u> 201	2	Au über/over Ni
02 02 160 <u>1</u> 201	1	Au über/over Ni
Bestell-Nr. Part-No.	Anforderungsstufe nach IEC performance level per IEC	Kontaktoberfläche Contact Plating

All Dimensions in mm Original Size DIN A 3			Techn. Character.			Nicht tolerierte Maß/Free size tolerances in Anlehnung an IEC 60603-2 / based on IEC 60603-2			
			Dat.	Name	Maßstab/Scale <b>1:1</b> (2:1)	har-bus 64 C Federleiste Einpreß , 160 pol. har-bus 64 C female connector press-in , 160 pol.			
			Detail.	09.10.96					Rie.
			Insp.	09.10.96					Pa.
			Stand.						
30809	12.02.02	Rie.	HARTING Electronics GmbH & Co. KG				<b>TB 02 02 160 x201</b>		
19811			D-32339 ESPELKAMP						
Mod.	Dat.	Name				Sub.	Blatt / page		

Alle Rechte vorbehalten. All rights reserved.