

Colour	Mfrs. List No.	Order Code	Price Each				
			1+	3+	5+	10+	15+
Red	515-501-04-50	948-779					
Yellow	515-521-04-50	948-780					
Green	515-532-04-50	948-792					
Blue	515-930-04-50	948-809					
White	515-997-04-50	948-810					

Large Area With or Without Resistor



Body length = 31.5
Bezel dia = 15.7
Mounting hole dia = 12.7
Flying lead length = 150.0

Large high brightness, push-fit panel mounting LEDs in bright chrome housing with an attractive chrome bezel and coloured lens. Built in reflector giving a wide viewing angle of 140°. These LEDs are available either with or without a current limiting resistor. Connection is via 0.187" push-on/solder lug terminals or by flying leads.

Without Resistor	Typ. Lum. Intensity	V _F typ.	@ I _F	V _R max.	Mfr. List No.	Order Code
●Red	13mcd	2.2V	30mA	5V	6340-002-505R	140-572
◆Red	13mcd	2.2V	30mA	5V	6340-302-505R	620-609
●Green	5mcd	2.2V	30mA	5V	6340-005-505G	140-573
◆Green	5mcd	2.2V	30mA	5V	6340-305-505G	620-610
●Amber	10mcd	2.2V	30mA	5V	6340-001-505A	140-574
◆Amber	10mcd	2.2V	30mA	5V	6340-301-505A	620-622

With Resistor	Typ. Lum. Intensity	@	Operating Current	V _R max.	Mfrs. List No.	Order Code
●Red	5Vdc	13mcd	30mA	5V	6342-002-505R	620-634
●Green	5Vdc	5mcd	30mA	5V	6342-005-505G	620-646
●Amber	5Vdc	10mcd	30mA	5V	6342-001-505A	620-658
●Red	28Vdc	7mcd	17mA	5V	6346-002-505R	620-660
●Green	28Vdc	3mcd	17mA	5V	6346-005-505G	620-671
●Amber	28Vdc	5mcd	17mA	5V	6346-001-505A	620-683

●Tab terminals ◆Flying leads

FOR MATCHING NEON INDICATORS SEE PAGE 273

OPT67

Colour	Voltage	Order Code	Price Each		
			1+	50+	100+
Red	—	.140-572			
Red	—	620-609			
Green	—	.140-573			
Green	—	620-610			
Amber	—	.140-574			
Amber	—	620-622			
Red	5V dc	620-634			
Green	5V dc	620-646			
Amber	5V dc	620-658			
Red	28V dc	620-660			
Green	28V dc	620-671			
Amber	28V dc	620-683			
Order Multiple=5			5+	50+	100+
Mounting clip				.140-575	

10mm – IP67 Rated 12V dc, 24V dc & 240V ac

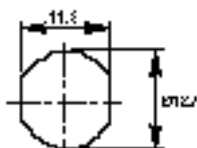

Mounting Hole
Overall L = 38.5
Total L behind bezel = 26.5
Bezel dia. = 17, Max panel thickness = 8
Tab connections 2.8 0.5

This range of LED indicators have 10mm tinted diffused LEDs in black anodised aluminium housings which are fully internally potted and sealed to IP67 rating making them suitable for applications where vibration occurs. Fitted with sealing ring, fixing nut and washer.

Operating current:	12V dc	20mA
	24V dc	20mA
	240V ac	3mA

Operating temperature range: -40°C to +86°C

Typical Luminous intensity @ I ₀ (mcd)	Red	Super Red	Green	Yellow
12V dc	90	500	40	40
24V dc	90	500	40	40
230V ac	90	500	40	40

OPT558

Colour	Order Code	Price Each				
		1+	10+	25+	50+	100+
12V dc						
Red	993-736					
Super Red	993-748					
Yellow	993-750					
Green	993-761					
24V dc						
Red	993-773					
Super Red	993-785					
Yellow	993-797					
Green	993-803					
240V ac						
Red	993-815					
Super Red	993-827					
Yellow	993-839					
Green	993-840					

12V dc, 24V dc and 230V ac

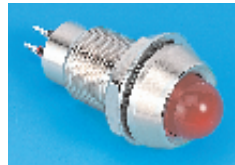

Mounting hole dia. = 12.7, Overall L = 38.5
Total L behind bezel = 26.5, Bezel dia. = 17,
Max. panel thickness = 8,
Tab Connections = 2.8 0.5

Operating Current:	12V dc	20mA
	24V dc	20mA
	240V ac	3mA

Operating temperature range: -40°C to +85°C

Typical luminous intensity I ₀ (mcd)	Red	Super Red	Green	Yellow
12V dc	40	200	40	40
24V dc	40	200	40	40
230V ac	5	15	3	5

OPT118

Colour	Order Code	Price Each				
		1+	10+	25+	50+	100+
12V dc						
Red	335-0873					
Super Red	335-0885					
Green	335-0897					
Yellow	335-0903					
24V dc						
Red	335-0915					
Super Red	335-0927					
Green	335-0939					
Yellow	335-0940					
240V ac						
Red	335-0952					
Super Red	335-0964					
Green	335-0976					
Yellow	335-0988					

10mm Wire Ended 2.5V dc



L behind bezel = 19, Bezel dia. = 16,
Thread = M14 1, Mounting hole dia. = 14.5

A range of panel mounted, wire ended indicators. They are fitted in high quality bright chrome or black chrome brass housings, fitted with fixing nut and washer. **CE approved.**

Operating voltage	2.5V dc	Operating current (max.)	30mA
Operating temperature	-55°C to +70°C		

Typical luminous intensity @ 20mA	HE Red	Green	Yellow
	65mcd	20mcd	23mcd

OPT319

Colour	Order Code	Price Each				
		1+	25+	100+	250+	500+
Bright Chrome						
HE Red	654-292					
Green	654-309					
Yellow	654-310					
Black Chrome						
HE Red	654-322					
Green	654-334					
Yellow	654-346					

continued