

	Order Code	1+	4+	20+
1" Square hole punch	100-636			
Allen key	100-640	1+	25+	50+
			100+	

171X

'D' Connector Punch

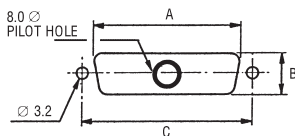

A range of 'D' connector hole punches suitable for use on mild steel up to 1.6mm (16 swg) and aluminium up to 2mm (14swg). They are available to suit either rear or front/through mounting of the connectors.

	9 Way		15 Way		25 Way		37 Way		50 Way	
	Front	Rear	Front	Rear	Front	Rear	Front	Rear	Front	Rear
A	21.3	19.8	29.6	28.2	43.4	41.9	59.8	58.4	55.7	
B	12.9	11.3	12.9	11.3	12.9	11.3	12.9	11.3	13.9	
C	25.0	25.0	33.3	33.3	47.0	47.0	63.5	63.5	61.1	

172

Connector	Mftrs. List No.	Order Code	1+	3+	10+
Connector Rear					
9 way	976-0010	.146-822			
15 way	976-0020	.146-823			
25 way	976-0030	.146-824			
37 way	976-0040	.146-825			
50 way	976-0050	.146-826			
Connector Front/Through Mounting					
9 way	975-0010	.146-817			
15 way	975-0020	.146-818			
25 way	975-0030	.146-819			
37 way	975-0040	.146-820			

Hydraulic Powered Hole Punches



Box: H = 150, W = 570, D = 230

- Hydraulic cylinder and ram for pulling hole cutters through mild steel and aluminium up to 3mm thick
- The ram has a stroke of 19mm and is connected to the pump by a 1.8m of hose
- Supplied in a metal storage case which accommodates additional hole punches

Punch mm	Pilot Hole mm	Special Uses	Mftrs. List No.	Order Code
22.5	13.5	22mm control + signal devices	942-0020	222-458
30.0	13.5	—	942-0050	222-483
45.0	27.5	DIN panel meters etc. 48 48mm	943-0010	222-525
68.0	35.0	DIN panel meters etc. 72 72mm	943-0020	222-537
92.0	35.0	DIN panel meters ect. 96 96mm	943-0030	222-549

Mftrs. List No. 942-0000 = 222-434

173X

	Order Code	1+	3+	6+
Pump and ram	.222-434			
Punches				
22.5	.222-458			
45.0	.222-525			
68.0	.222-537			
92.0	.222-549			

Hole Punch & Die Sets



3 Point



- A range of hole cutters in industry standard sizes for use with a hydraulic gun or bearing bolt
- When using the hydraulic gun will punch burr free holes in up to 3.00mm thick stainless steel
- When using the bearing bolt will punch burr free holes in up to 3.00mm thick aluminium and mild steel
- The punch and die are made from high quality tool steel, hardened, tempered and finished black zinc
- The punch splits slugs into multi segments for easy removal from die
- Bearing bolts are of high tensile steel, hexagonal with captive thrust bearing to allow hand operation of 937 range of punches and dies.
 - 9.5mm 50mm long bolt for use with \varnothing 12.7mm to \varnothing 26.0mm cutters
 - 19mm 50mm long bolt for use with \varnothing 28.3mm to \varnothing 43.2mm cutters
 - 19mm 75mm long bolt for use with \varnothing 49.6mm to \varnothing 61.5mm cutters

107X

Hole Cutter (mm)	Mftrs. List No.	Order Code	1+	5+	10+	25+	50+
12.7	9370010-01	724-8647					
15.2	9370020-01	724-8659					
16.0	9370030-01	724-8660					
18.0	9370040-01	724-8672					
18.6	9370050-01	724-8684					
19.0	9370060-01	724-8696					
20.0	9270070-01	724-8702					
20.5	9370080-01	724-8714					
22.5	9370090-01	724-8726					
26.0	9370100-01	724-8738					
28.3	9370110-01	724-8740					
30.5	9370120-01	724-8751					
32.7	9370130-01	724-8763					
34.6	9370140-01	724-8775					
37.0	9370150-01	724-8787					
40.0	9370160-01	724-8799					
43.2	9370170-01	724-8805					
49.6	9370180-01	724-8817					
Bearing Bolt Size							
9.5 50	9360050-01	724-8854					
19 50	9360060-01	724-8866					
19 75	9360070-01	724-8878					

Hydraulic Gun Kits



Hole Punches



- Compact lightweight portable hydraulic gun kits supplied in a carry case complete with two drawbolts for use with the 3 point punch and die sets
- The straight kit is designed for fast action straight in-line front panel hole punching, whilst the swivel kit can be used at any angle and is designed for punching in awkward positions
- Either kit needs only one operator and removes most of the effort when cutting holes by hand
- When punching holes up to \varnothing 25mm a pilot hole of \varnothing 11.5mm requires drilling. Holes larger than \varnothing 26mm require a pilot hole of \varnothing 25.5mm

194X

	Mftrs. List No.	Order Code	1+	5+	10+	25+	50+
Hydraulic Gun Kit, Straight	9360010-01	724-8880					
Hydraulic Gun Kit, Swivel	9360020-01	724-8891					
Drawbolt 9.5mm 19mm	9360030-01	724-8908					
Drawbolt 19mm	9360040-01	724-8910					

continued