

## Camaster

## Bussmann

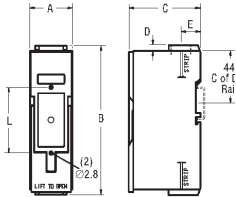

Fuse Size	Rating Amps	Max. Cable mm <sup>2</sup>	Fuse Type	Dimensions					Mfrs. List No.	Order Code
				A	B	C	D	E		
A1	32	16	NITD	25.4	93.7	60	3.2	17.5	CM32FC	556-361
A2	32	16	AAO	31.8	117.5	60	3.2	17.5	CM32F	556-373
A3	63	70	BAO	35.6	125	60	4.75	16.4	CM63F	556-385
A3	100	70	OCD	35.6	125	60	4.75	16.4	CM100F	968-766

A range of fully shrouded HRC fuseholders designed to accommodate offset bolted tag HRC fuselinks to **BS88 (Parts 1 & 2)** and **IEC 269-1 & 2 1986**.

These fuseholders feature a lever operated cam for easy removal of the fuse carrier from the base. This allows increased pressure between fuse carrier and fuse base contacts thus enhancing the electrical performance. Fuselink fixing screws remain captive in the fuse carrier to prevent their loss when fuse changing. Suitable for DIN rail or panel mounting. Supplied as front connection.

FUS250X

Fuse Size	Fuse Type	Order Code	Price Each			
			1+	10+	20+	50+
A1	NITD	<b>556-361</b>				
A2	AAO	<b>556-373</b>				
A3	BAO	<b>556-385</b>				
A3	OCD	<b>968-766</b>				

## 'Redspot' Series A1 to A4 and B2

## GECA LVE

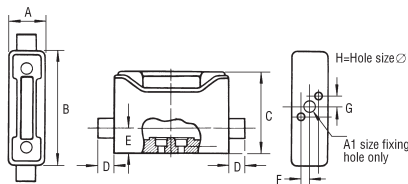

Fuse Carrier Size	Fuse Size	Max. Cable Size(mm <sup>2</sup> )	Max Current Rating	Dimensions							
				A	B	C	D	E	F	G	H
A1	A1	10	20A	27	80	54	15	22	—	—	5.5
A2	A2	16	32A	32	104	70	15	22	6.4	3.2	5.5
A3	A2/3	50	63A	35	110	76	15	24	6.4	3.2	6.6
A4	A4	70	100A	51	140	100	15	28	9.5	11.1	6.6
B2	B2	120	200A	70	216	137	22	32	19	28.6	6.6

**Notes:** A1 size fuse carrier has one central fixing hole A2, A3, A4 and B2 sizes are two hole fixing (see diagram above). B2 size fuse carrier has a different style handle to that shown in the diagram above.

**GECA 'Redspot'** fuse carriers are widely accepted as an industry standard for use with **BS88** fuses.

Moulded from a flame retardant non-hygroscopic phenolic resin to **BS771** they are available in black or white (B2 Black only).

The patented non-twist cable clamping screw of large diameter complies with **CEGB** requirements for **Class II duty**, whilst contacts are single screw fixing with large contact area and anti-vibration features.

**Approved by Lloyds** register for marine applications, **CEGB approval Nr.29** for **Category II duty**.

Size	Black		White	
	Mfrs. List No.	Order Code	Mfrs. List No.	Order Code
A1	RS20H	177-604	RS20H WHITE	237-346
A2	RS32H	177-605	RS32H WHITE	237-358
A3	RS63H	177-606	RS63H WHITE	237-360
A4	RS100H	177-607	RS100H WHITE	237-371
B2	RS200H	177-608	—	—

FUS92X

Size	Colour	Order Code	Price Each			
			1+	10+	50+	100+
A1	Black	<b>177-604</b>				
A1	White	<b>237-346</b>				
A2	Black	<b>177-605</b>				
A2	White	<b>237-358</b>				
A3	Black	<b>177-606</b>				
A3	White	<b>237-360</b>				
A4	Black	<b>177-607</b>				
A4	White	<b>237-371</b>				
B2	Black	<b>177-608</b>				

## Safeloc

## Bussmann

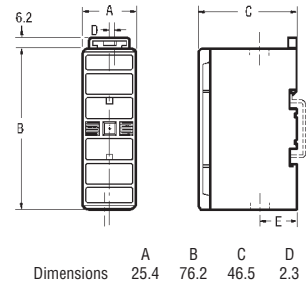

Designed to accommodate the F1 size of **BS88** offset blade fuselinks. Featuring a unique slide action carrier, which retains the fuselink for easy insertion to the base. The fuselink blades connect directly with the shrouded base contacts for improved reliability and lower losses. Terminal screws are semi-captive and are front connection. Suitable for 35mm DIN rail or single screw mounting.

Rating 32A Max. cable size 16mm<sup>2</sup> Fuse size F1  
Mfrs. List No. 32NNSF

FUS249X

Fuse Size	Order Code	Price Each			
		1+	10+	25+	100+
F1	<b>556-154</b>				

## European 'D' Fuses and Accessories

### Ultra Rapid (gr). DII & DIII Series



- High breaking capacity, low power loss
- Class gR
- For protection of semiconductors and small drive units
- Conforms to **DIN49515** and **VDE0636-33**
- Suitable for 3-phase applications

Working voltage 500Vac 440Vdc  
Breaking capacity 50kA

L DII = 50, DIII = 50  
Dia DII = 22, DIII = 27

FUS249A

Current Rating (A)	Power Dissipation (W)	Order Code	Price Each			
			1+	25+	100+	250+
<b>Type DII</b>						
2	1.8	<b>.901-908</b>				
4	3.1	<b>.901-910</b>				
6	4	<b>.901-921</b>				
10	6	<b>.901-933</b>				
16	7	<b>.901-945</b>				
20	8	<b>.901-957</b>				
25	10	<b>.901-969</b>				
30	12	<b>.901-970</b>				
<b>Type DIII</b>						
35	13	<b>.902-056</b>				
50	16	<b>.902-068</b>				
63	19	<b>.902-070</b>				

Continued