

## Adaptors

2mm to 4mm, 4mm to 2mm

**MC**

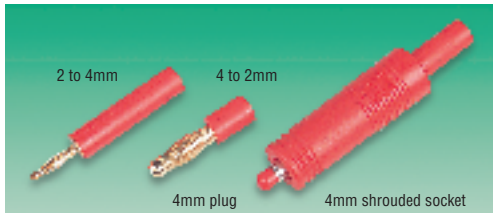

A range of adaptors suitable for converting and inter-connecting 2mm and 4mm connecting leads and plugs. Also a 4mm plug protected by a retractable shroud to convert to a 4mm shrouded socket. Maximum current 25A.

Mfrs. List No. 24.0115-1 = 152-740, 24.0115-4 = 152-741, 24.0106-1 = 152-742  
24.0106-4 = 152-743, 24.0116-1 = 462-834

		Price Each				
Colour	Order Code	1+	10+	25+	50+	100+
<b>2mm Plug – 4mm Socket</b>						
Red	.152-740					
Black	.152-741					
<b>4mm Plug – 2mm Socket</b>						
Red	.152-742					
Black	.152-743					
<b>4mm Plug – 4mm Shrouded Socket</b>						
Red	462-834					

## 3mm Connectors

### 3mm 10A

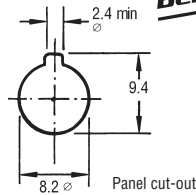

**Belling Lee**

Uses the O-Z principle which is devised to provide particularly low resistance so that heavy current contacts will not jump out under vibration.

Break down voltage 5kV dc Housing Polypropylene  
Current rating 10A Maximum cable entry for L378A3 4mm  
Maximum temperature +85°C

		Price Each			
Mfrs. List No.	Order Code	1+	100+	250+	500+
<b>Free Plug</b>					
L378A3/RED	317-093				
L378A3/BLACK	317-100				
<b>Panel Socket</b>					
L1317/RED	317-111	1+	250+	500+	1000+
L1317/BLACK	317-123				

## 4mm Plugs and Sockets

### 4mm Couplers



Socket to socket L = 44, Dia. = 10  
Free socket solder termination L = 48, Dia. = 11

Insulated couplers for two 4mm dia. plugs or one plug and wire with solder connection.

Operating voltage 50V  
Continuous load current 10A  
Contact resistance 5mΩ max.  
Temperature range -25°C to +70°C  
Housing Polystyrol **UL94-HB (KD10)**  
PVC (KUN30)  
Brass, nickel plated



Mfrs. List No. KD 10+colour Socket to socket, KUN 30+colour Free socket, solder terminal, KUN10+colour Free Socket, Screw Terminal

		Price Per Pack				
Order Code	1+	10+	25+	50+	100+	
<b>Socket to Socket</b>						
Red	496-017					
Black	496-029					
<b>Free Socket</b>						
Red	496-110					
Black	496-121					
Blue	810-186					
<b>Free Socket, Screw Terminal</b>						
Red	810-162					
Black	810-150					

## 4mm 10A



**CLIFF**

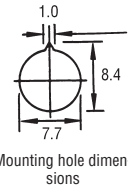

Plug: Cover length = 34, Cover dia = 6.5, Overall length = 45  
Socket: L = 28, Dia = 12, Maximum panel thickness = 13.5

A low cost range of 4mm plugs and sockets featuring slim style plugs and small diameter sockets enabling increased stacking density.

Mfrs. List No. Plugs P14+Colour, Sockets S14+Colour

Free Plugs					
Colour	Order Code	Colour	Order Code	Colour	Order Code
Red	143-556	Green	143-558	Yellow	143-560
Black	143-557	Blue	143-559	White	143-561
Order Multiple=5					
Order Code	5+	50+	100+	250+	500+
All colours					
Panel Sockets					
Colour	Order Code	Colour	Order Code	Colour	Order Code
Red	145-299	Green	145-301	Yellow	145-303
Black	145-300	Blue	145-302	White	145-304
Order Multiple=5					
Order Code	5+	50+	100+	250+	500+
All colours					

## 4mm Plugs 10A



**DELTRON**

A range of tubular turned contact 4mm plugs with stainless steel spring contacts. They feature robust tubular solder bucket termination, enabling the plugs to be re-used many times.

Current rating 10A Contacts: Body Spring Brass, nickel alloy plated  
Housing Acetal Stainless steel

Mfrs. List No. 550-0500 = 149-414, 550-0400 = 149-537, 550-0700 = 149-539  
550-0100 = 149-536, 550-0200 = 149-538, 550-0600 = 149-540

		Price Each			
Colour	Order Code	Colour	Order Code	Colour	Order Code
Red	.149-414	Green	.149-537	Yellow	.149-539
Black	.149-536	Blue	.149-538	White	.149-540
Order Multiple=5					
Order Code	5+	10+	100+	250+	500+
.All colours					

## 4mm Stackable Plugs 10A



**DELTRON**

A range of solid turned contact 4mm plugs with a 4mm socket in the rear. Cable connection options, solder or screw (grub screw is accessed via socket tube), cable entry up to 1.5mm<sup>2</sup> cross section.

L = 50, W = 10, H = 11.5  
Contacts: Body Spring Brass, nickel plated  
Stainless steel

Mfrs. List No. 553-0500 = 149-415, 553-0400 = 149-542, 553-0700 = 149-544  
553-0100 = 149-541, 553-0200 = 149-543, 553-0600 = 149-545

		Price Each			
Colour	Order Code	Colour	Order Code	Colour	Order Code
Red	.149-415	Green	.149-542	Yellow	.149-544
Black	.149-541	Blue	.149-543	White	.149-545
Order Multiple=5					
Order Code	5+	50+	100+	250+	500+
.All colours					

continued