

Rated Voltage 250V
 Maximum Voltage 415V
 Current Rating 24A
 Temperature Range -30 to +105°C
 Flammability Class UL94V-0

Solid wire entry
 Screw size M3
 Torque rating 0.5Nm
 Colour **Dark grey**

2.5 sq mm

CP401

No. of Ways	Mftrs. List No.	Order Code	Price Each				
			1+	50+	100+	500+	1000+
2	20.100/2	304-4531					
3	20.100/3	304-4543					
4	20.100/4	304-4555					
6	20.100/6	304-4567					
8	20.100/8	304-4579					
10	20.100/10	304-4580					

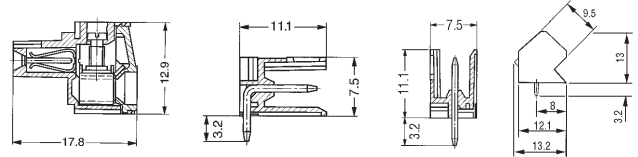

Voltage rating (VDE) 125V ac (Group C) Screw clamp
 250V ac (Group B) Contact pin
 Current rating 10A Housing
 Temperature range -20°C to +100°C Colour
 Wire size

Steel, zinc plated
 Copper alloy, tin plated
 PBT
 Orange
 0.5-1.5mm²

Mftrs. List No.: BL3.5/x SL3.5/x/90G
 BLZF3.5/x SL3.5/x/180G
 SL3.5/x/135
 Where x = No. of ways

CP70
 CP70a

10A 10mm Pitch



2.5mm²
 cable entry

- 2.5mm² cable entry
- Pressure plate wire entry assists conductor clamping



H = 13, W = 8, Pitch = 10, Pin dia = 1.1

Maximum voltage 380V ac Housing Noryl SE.1
 Current rating 10A Colour Light Grey
 Maximum temperature 120°C Maximum wire size 2.5mm²

Warning: Not suitable for use with Arklone cleaners

CP204

Order Multiple=5

No. of Ways	Length mm	Order Code	Price Each			
			5+	50+	100+	500+
2	15	147-917				
3	25	147-918				
4	35	147-919				

12 Way 5A 6.35mm Pitch

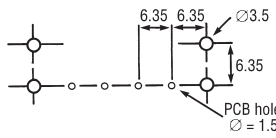
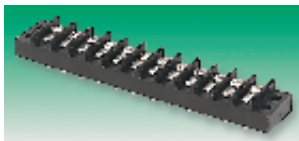

H = 8.7, W = 16, L = 89, Pins = 4.0 1.5 0.6
 Max. fork width = 5.2

PCB drilling pattern

Maximum working voltage 380V ac Housing Glass filled polyester
 Current rating 5A Colour Red
 Temperature range -25°C to +85°C Screw terminations 6BA

CP206

Order Code	Price Each				
	1+	10+	50+	100+	250+
105-369					

2 Way Tab Terminals 10A 5mm Pitch

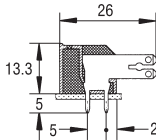

Style A

PCB drill size, 1mm force fit, 1.3mm clearance

Contact rating 10A @ 250V ac Housing Green polyamide 6.6, UL94V-2

Mftrs. List No. FL2H = 150-354

CP209

Order Code	Price Each				
	1+	5+	10+	50+	100+
Style A 150-354					

Plug-In PCB Mounting Terminal Blocks

Plug-in 10A 3.5mm Pitch

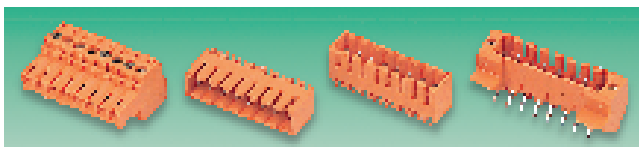

No. of Ways	Order Code	Price Each			
		1+	25+	100+	500+
Free Plug - BL					
2	.617-350				
3	.617-362				
4	.617-374				
5	.617-386				
6	.617-398				
8	.617-404				
10	.617-416				
12	.617-428				
14	.617-430				
16	.617-441				

No. of Ways	Order Code	Price Each			
		1+	25+	100+	500+
Free Plug - BLZF Series					
2	155-354				
3	155-366				
4	155-378				
5	155-380				
6	155-391				
8	155-408				
10	155-410				
12	155-421				
14	155-433				
16	155-445				

No. of Ways	Order Code	Price Each			
		1+	25+	100+	500+
Order Multiple=5 Side Entry PCB Header-Closed End					
2	.617-453				
3	.617-465				
4	.617-477				
5	.617-489				
6	.617-490				
8	.617-507				
10	.617-519				
12	.617-520				

No. of Ways	Order Code	Price Each			
		1+	25+	100+	500+
Order Multiple=1 Side Entry PCB Header-Closed End					
16	.617-544				

No. of Ways	Order Code	Price Each			
		1+	25+	100+	500+
Order Multiple=5 Top Entry PCB Header-Closed End					
2	.617-556				
3	.617-568				
4	.617-570				
5	.617-581				
6	.617-593				
8	.617-600				
10	.617-611				
12	.617-623				
14	.617-635				

No. of Ways	Order Code	Price Each			
		1+	25+	100+	500+
Order Multiple=1 Top Entry PCB Header-Closed End					
16	.617-647				

No. of Ways	Order Code	Price Each			
		1+	25+	100+	500+
Order Multiple=5 135° PCB Header-with fixing flange					
2	.617-659				
3	.617-660				
4	.617-672				
5	.617-684				
6	.617-696				
8	.617-702				
10	.617-714				

No. of Ways	Order Code	Price Each			
		1+	25+	100+	500+
Order Multiple=1 135° PCB Header-with fixing flange					
16	.617-740				

continued