

Non-Insulated Crimp Terminals — Continued

Ring Terminals

SOLISTRAND® Ring Terminals



- Designed to accept solid, stranded or irregular shaped copper wires
- Available in ring, spade/fork, parallel splice and butt splice
- Manufactured from high conductivity annealed copper
- Brazed barrel seams with electro-tin plated finish
- Serrated/dimpled surface for improved conductivity
- Temperature rating 170°C max.
- Approved **CAA, UL, MOD, CSA** and **BS46178**

Recommended Crimping Tools

Wire Size	AMP Crimp Tool	Order Code	See Page
0.25-6.6mm ² (22-10 AWG)	(169400 Tool)	587-357	230
	(169409 Die Set)	970-657	230
6.7mm ² -76.2mm ² (8-2/0 AWG)	600850-0	970-967	236

CS446

Stud Size	Stud Size	Pack Qty	Mftrs. List No.	Order Code	Price Per Pack
Metric	Imperial				1+ 5+ 10+ 25+ 50+

Wire Range 0.25-1.6mm² (22-16AWG.)

M2.5	6BA	100	34104	213-7574
M3/3.5	4BA	100	34105	214-0779
M4	3BA	100	34108	213-9900
M4.5	2BA	100	34109	213-9224
M5	2BA	100	130017	970-670
M6	0BA	100	34113	213-7914

Wire Range 1.0-2.6mm² (16-14 AWG.)

M3/3.5	4BA	100	34120	213-9261
M4	3BA	100	34122	213-9273
M4.5	2BA	100	34123	213-9297
M5	2BA	100	130106	970-682
M6	0BA	100	34124	214-2399
M8	5/16"	100	34125	213-7501
M10	3/8"	100	34126	213-7902

Wire Range 2.7-6.6mm² (12-10 AWG.)

M3/3.5	4BA	100	33456	970-694
M4	3BA	100	32994	970-700
M4.5	2BA	100	33457	213-9170
M5	2BA	100	130191	970-712
M6	1/4"	100	33458	176-7124
M8	5/16"	100	33459	176-7136
M10	3/8"	100	33220	213-7379

Wire Range 6.7-10.5mm² (8 AWG)

M5	2BA	50	160013	970-803
M6	0BA	50	35247	214-2454
M8	5/16"	50	33462	213-9212
M10	3/8"	50	160056	970-736
M12	1/2"	50	35664	970-815

Wire Range 10.6-16.7mm² (6 AWG)

M5	2BA	25	130552	970-827
M6	0BA	25	33465	185-3685
M8	5/16"	25	33466	213-7872
M10	3/8"	25	160032	970-750
M12	1/2"	25	36808	970-761
M16	5/8"	25	36809	970-839

Wire Range 16.8-26.6mm² (4 AWG)

M6	0BA	25	33469	214-3240
M8	5/16"	25	33470	214-3252
M10	3/8"	25	160075	970-773
M12	1/2"	25	35668	970-785
M16	5/8"	25	35669	970-797

Wire Range 26.7-42.4mm² (2AWG)

M8	5/16"	25	322870	213-8864
M9	3/8"	25	35184	970-840
M10	3/8"	25	321600	185-3740
M12	1/2"	25	35185	970-852
M16	5/8"	25	320754	140-9281

Wire Range 42.5-60.5mm² (1/0 AWG)

M8	5/16"	25	321867	213-8876
M9	3/8"	25	36917	213-8888
M12	1/2"	25	36919	140-9323
M16	5/8"	25	320744	970-890

Wire Range 60.6-76.2mm² (2/0 AWG)

M8	5/16"	25	36922	140-9347
M9	3/8"	25	36923	213-8906
M12	1/2"	25	36925	213-8918
M16	5/8"	25	322224	140-9360

Rotacrimp and Bantam Rotacrimp For Heavy Duty SOLISTRAND® Terminals



- For SOLISTRAND uninsulated terminals
- Bantam Rotacrimp covers wire sizes 6.7-60.5mm² (8-1/0 AWG)
- Standard Rotacrimp covers wire sizes 6.7-76.2mm² (8-2/0 AWG)
- Manufactured from high strength alloy steel

FOR SMALLER GAUGE AMP 'CERTILOK' HAND CRIMP TOOL
SEE ORDER CODE 587-357 **PAGE 230**

CS447

	Mftrs. List No.	Order Code	Price Each
			1+ 3+ 5+
Bantam Rotacrimp	601075-0	970-955	
Standard Rotacrimp	600850-0	970-967	



DAVICO

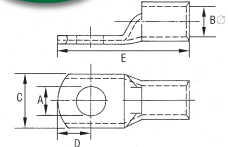

Copper tube terminals electro tinned to **BS1872** (1984), **IEC352-2** and **ISO1966**. Chamfered cable entry aids cable insertion and even crimping.

Note: When using flexible fine strand or welding cable it may be necessary to select the next larger terminal size ie 35mm² fine strand select 50mm² terminal. The size of solid wire in mm² and the equivalent size of fine strand wire is marked on each terminal.

Solid Wire Size mm ²	Stud Size	ØA	ØB	C	D	E	Mftrs. List No.	Order Code
6	5	5.2	3.8	10	5	23	D 6-5	269-074
6	6	6.5	3.8	12	6	27	D 6-6	269-086
10	5	5.2	4.5	12	6	25	D 10-5	268-938
10	6	6.5	4.5	12	6	25	D 10-6	268-940
10	8	8.4	4.5	12	6	27	D 10-8	268-951
10	10	10.5	4.5	18	9	31	D 10-10	472-669
16	6	6.5	5.4	12	7	30	D 16-6	268-975
16	8	8.4	5.4	12	7	32	D 16-8	268-987
16	10	10.5	5.4	18	9	35	D 16-10	472-670
25	6	6.5	6.8	13	7	30	D 25-6	268-999
25	8	8.4	6.8	16	10	37	D 25-8	269-001
25	10	10.5	6.8	16	10	37	D 25-10	269-013
35	8	8.4	8.2	15.3	9	35	D 35-8	269-025
35	10	10.5	8.2	18	10	38	D 35-10	269-037
35	12	13.0	8.2	18	10	38	D 35-12	472-682
50	8	8.4	9.5	18	10	43	D 50-8	269-049
50	10	10.5	9.5	18	10	43	D 50-10	269-050
50	12	13.0	9.5	20	12	47	D 50-12	472-694

CS424X

10 Per Pack

Solid Wire Size mm ²	Stud Size	Order Code	Price Per Pack
			1+ 10+ 25+ 50+
6	5	269-074	
6	6	269-086	
10	5	268-938	
10	6	268-940	
10	8	268-951	
10	10	472-669	
16	6	268-975	
16	8	268-987	
16	10	472-670	
25	6	268-999	
25	8	269-001	
25	10	269-013	
35	8	269-025	
35	10	269-037	
35	12	472-682	
50	8	269-049	
50	10	269-050	
50	12	472-694	

DIN 46235

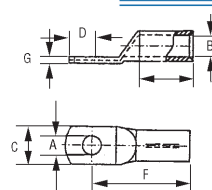

Electro tinned copper tube terminals to **DIN 46235**

- Inspection hole for wire depth, order codes **745-820, 745-832**
- Chamfered cable entry

Note: When using fine strand flexible wire or welding cable it may be necessary to use the next gauge up in wire size mm² to enable easier cable entry.